

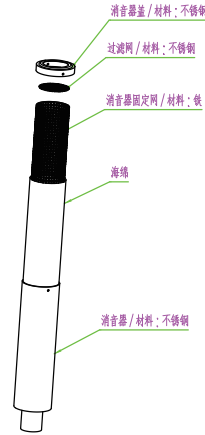

Side Channel Blower Silencer

Configuration



Mounting Dimensions

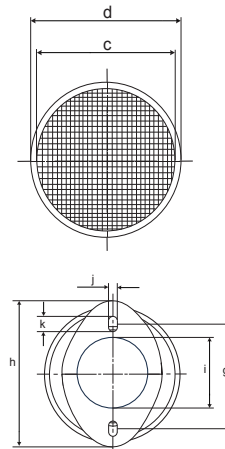
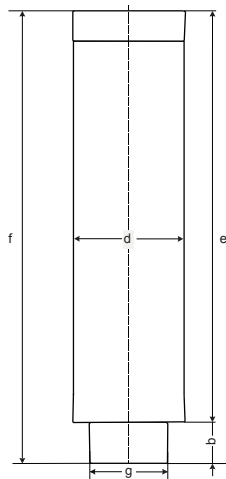
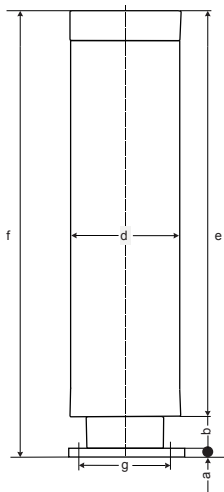

Selection & Data Sheet

| specification | Diameter of thread g | External diameter(mm) d | e(mm) | b(mm) | f(mm) | Weight |
|---------------|----------------------|-------------------------|-------|-------|-------|--------|
| 1" | G1 1/4 | 76 | 200 | 30 | 260 | 0.7kg |
| 1.2" | G1 1/4 | 76 | 200 | 30 | 260 | 0.7kg |
| 1.5" | G1 1/2 | 89 | 250 | 30 | 310 | 1.1kg |
| 2" | 2" | 102 | 300 | 35 | 370 | 1.4kg |
| 2.5" | G2 1/2 | 133 | 500 | 46 | 592 | 2.9kg |
| 3" | 3" | 159 | 500 | 50 | 600 | 3.4kg |
| 4" | 4" | 159 | 500 | 50 | 600 | 3.8kg |
| 4" | 4" | 159 | 1000 | 50 | 1100 | 7.6kg |

Changes in particular the quoted performance curve, datas and weights without prior notice. The figures are without obligations.